

Notes of Survey and Plan from
Government Survey made from survey by

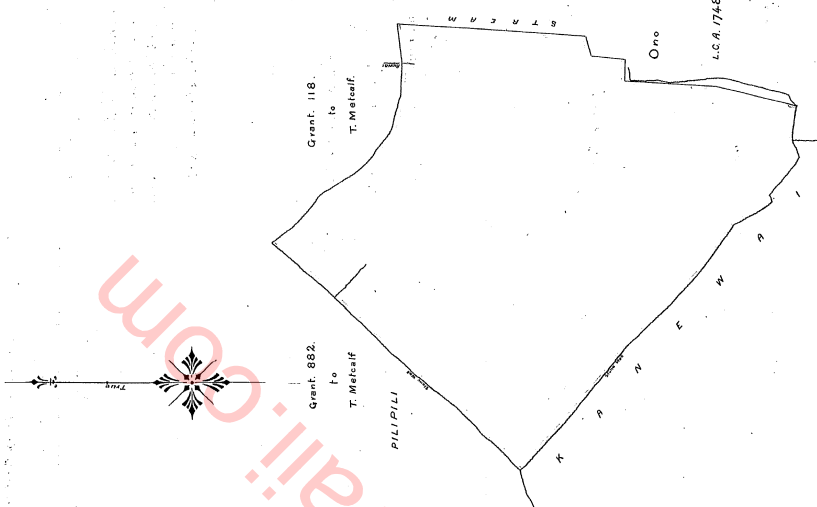

BEARINGS True	DISTANCES		REMARKS	BEARINGS		DISTANCES		REMARKS
	Feet	Links		Chain	Links	Chain	Links	
1. S. 82° 52' W.	134.		Commencing at the Point East corner of the lot at station and running along Grant 118 & J. Metcalf to stone wall at corner.					
2. N. 89° 37' W.	81.							
3. N. 77° 40' W.	155.							
4. N. 59° 25' W.	74.5							
5. N. 50° 12' W.	110.							
6. N. 30° 20' W.	126.5							
7. N. 55° 20' W.	95.							
8. N. 41° 32' W.	145.							
9. S. 43° 22' W.	657.							
10. S. 38° 33' W.	161.5							
11. S. 44° 25' W.	313.5							
12. S. 44° 20' E.	300.							
13. S. 61° 30' E.	287.							
14. S. 46° 18' E.	182.							
15. S. 49° 15' E.	140.							
16. S. 55° 15' E.	208.							
17. S. 29° 45' E.	145.							
18. N. 80° 00' E.	34.							
19. S. 53° 00' E.	162.							
20. N. 65° 00' E.	65.							
21. S. 85° 35' E.	120.1							
22. N. 12° 25' E.	278.							
23. N. 31° 25' E.	293.7							
24. S. 87° 50' E.	71.8							
25. N. 51° 22' E.	112.2							
26. N. 72° 35' E.	66.							
27. N. 31° 51' E.	616.							

WWW.CROWNOFFHAWAII.COM



Scale 200 Feet to one Inch

L. B. Owens 1748 to Oho
Area 32 765 Acres.
January 1884.